

### 15 D Commissioning a dual agent system with integrated valve



1

To begin the commissioning procedure first make the pipework safe by blanking off the discharge ports on the valve. From both cylinders

2

Screw the DDV (discharge delay valve) into the pressure switch port of the **powder** cylinder and connect the trace detection tube from the DDV to the foam cylinder as pictured at bottom of the page.

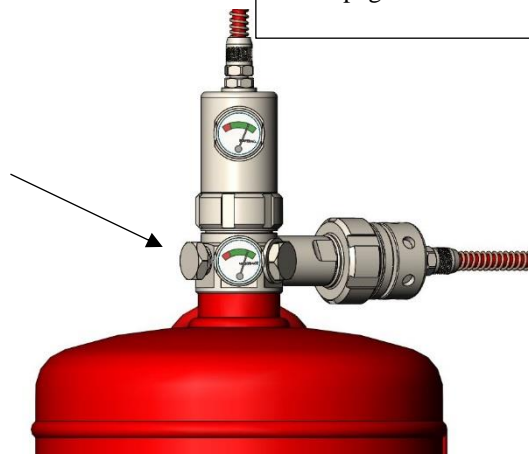

3

Using the FSCK set the pressure to 12 bar. Both parts of the detection tube will need to be pressurized before either cylinder can be commissioned. Pressurize the tube on the powder system first and then the link from the DDV to the foam system. Once pressure testing is complete the cylinders can be commissioned using the valve key. Insert key and turn anti clockwise to commission the powder first and then the foam cylinder

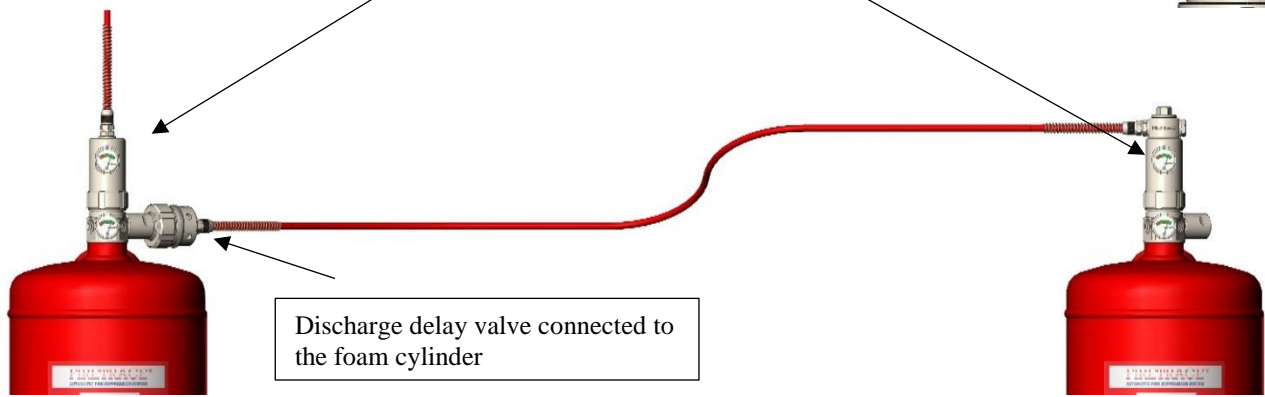
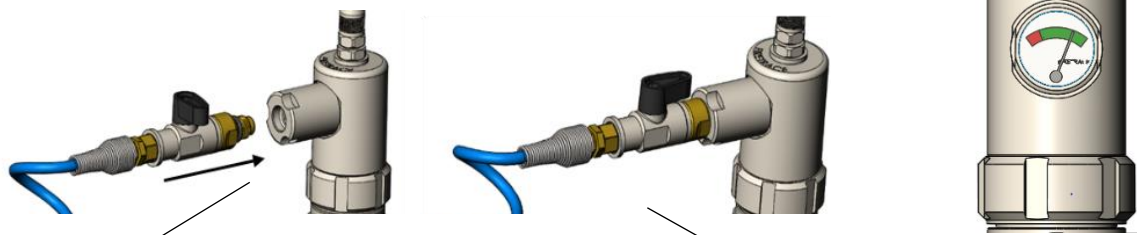

Discharge delay valve connected to the foam cylinder